



GIVE YOUR EQUIPMENT A VOICE

Tag to Connect Equipment to the Digital World

Asset Intelligence for Healthcare & Life Sciences

Equip ID is a next-generation Asset Management and Equipment Intelligence Platform for Healthcare and Life Science institutions. It transforms ultra-low temperature (ULT) freezers, medical imaging chillers, and temperature controlled research equipment into intelligent, traceable assets. With real-time visibility into compliance, service history, and maintenance, Equip ID optimizes equipment uptime, streamlines audits, and ensure regulatory readiness all from one intuitive platform



AFFIXING NFC/QR-CODED TAGS TO EACH ASSET, EQUIP ID DIGITIZES SERVICE HISTORY, COMPLIANCE RECORDS, MANUALS, DIAGNOSTICS, AND MORE. THE RESULT: A LIVING DIGITAL TWIN OF EACH ASSET, ACCESSIBLE BY SCANNING THE TAG WITH A MOBILE DEVICE

COMPLIANCE

Our app streamlines compliance by digitizing, maintenance, audits, and verifying technician presence at your asset

DIGITAL TWIN

Transform your assets into digital twins with our advanced asset tagging program

CURATED CONTENT

Connect with a tap! Instantly access service history, manuals, videos, warranties, parts, and more

User Experience Benefits

For Technicians

- Faster diagnostics
- Reduced errors
- Streamlined parts ordering

For Researchers

- Uninterrupted experiments
- Compliance assurance
- Optimal equipment scheduling

For Management

- Data-driven decisions
- Reduced administrative burden
- Extended equipment lifespan



100%
Asset Visibility

Complete oversight of all equipment



40%
Time Savings

Complete oversight of all equipment



30%
Cost Reduction

Complete oversight of all equipment



GIVE YOUR EQUIPMENT A VOICE

Tag to Connect Equipment to the Digital World

EQUIPMENT INTELLIGENCE

Delivered to the right person at the right time

- Equipment-specific data
- Actionable "Equipment Intelligence"
- Streamlining
 - Compliance
 - Inspections
 - Testing
 - Maintenance
 - Repair of Mission-Critical Assets

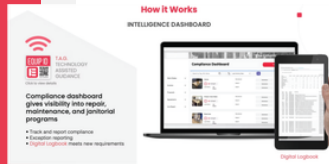

Compliance Dashboard



Creating Equipment Intelligence



Access to Equipment Intelligence

MOBILE APPLICATION

Available on the App Store

- Real-time scanning
- ULT freezer diagnostics
- Service history access
- On-site and off-site repair workflows
- Machine learning for field techs
- Compliance documents

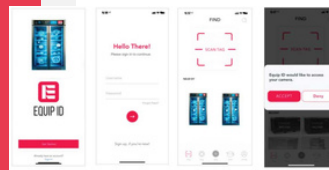

Homepage

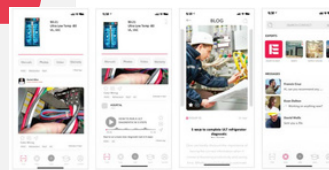

Details



Parts